

# TREE PROTECTION PLAN

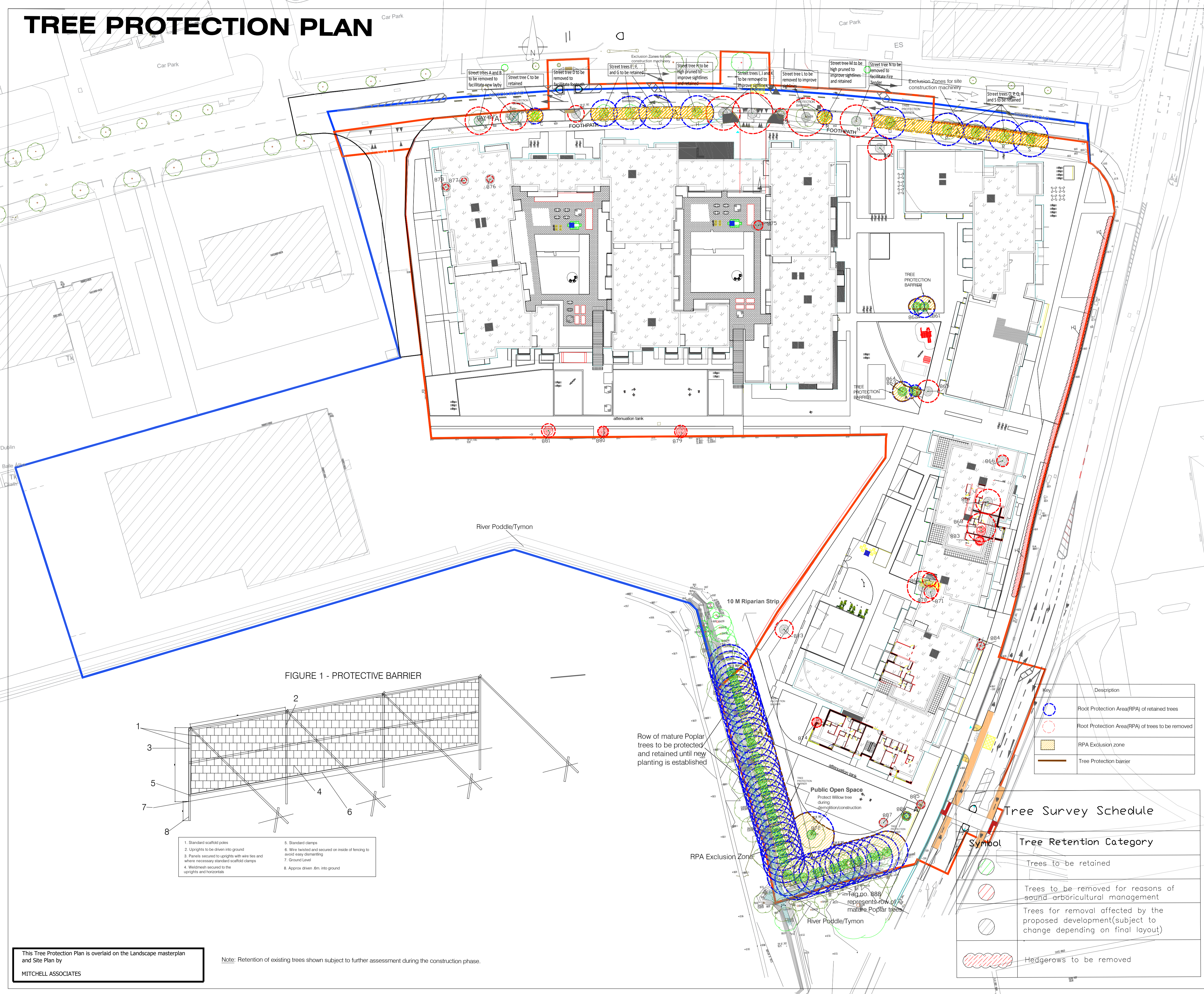
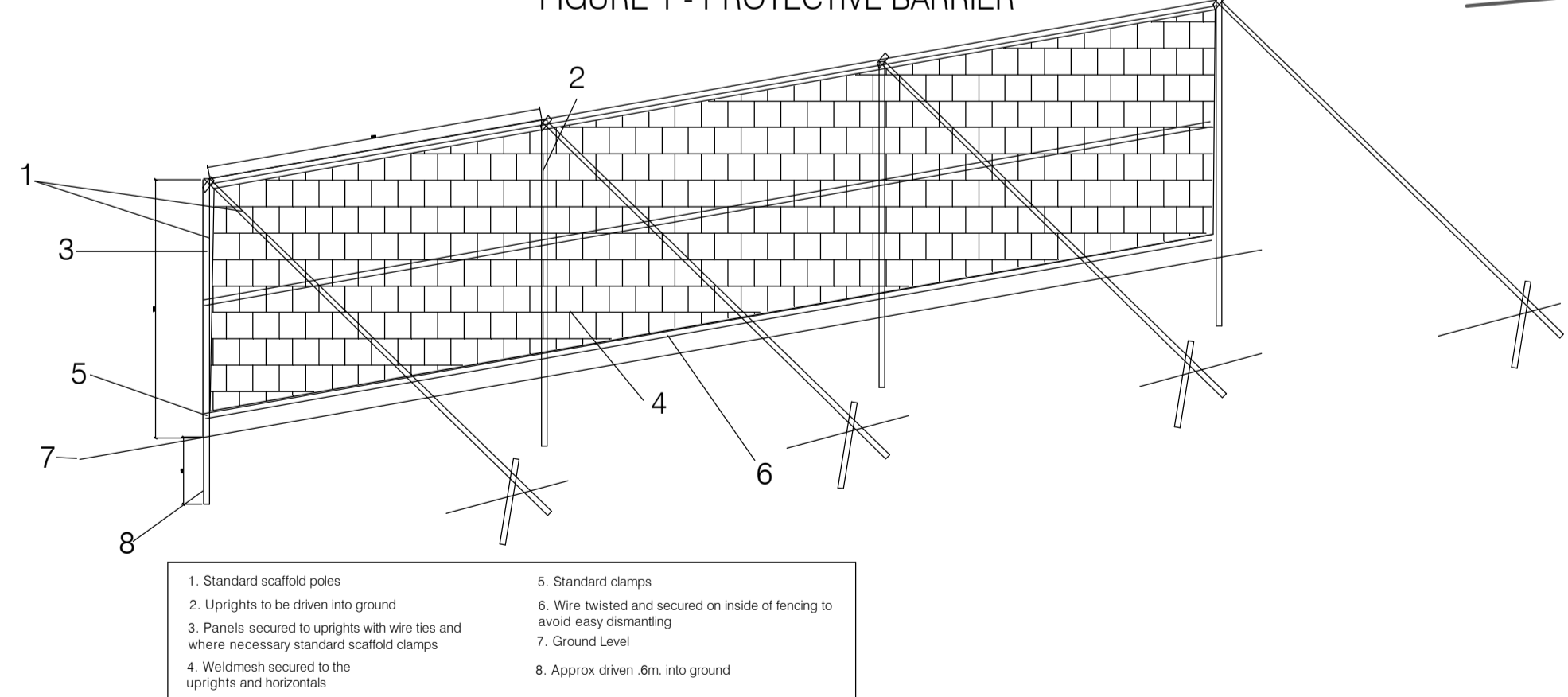

FIGURE 1 - PROTECTIVE BARRIER



- 1. Standard scaffold poles
- 2. Uprights to be driven into ground
- 3. Panels secured to uprights with wire ties and where necessary standard scaffold clamps
- 4. Wiremesh secured to the uprights and horizontals
- 5. Standard clamps
- 6. Wire twisted and secured on inside of fencing to avoid easy dismantling
- 7. Ground Level
- 8. Approx driven 6m into ground

Row of mature Poplar trees to be protected and retained until new planting is established

Key	Description
	Root Protection Area(RPA) of retained trees
	Root Protection Area(RPA) of trees to be removed
	RPA Exclusion zone
	Tree Protection barrier

Symbol	Tree Retention Category
	Trees to be retained
	Trees to be removed for reasons of sound arboricultural management
	Trees for removal affected by the proposed development (subject to change depending on final layout)
	Hedgerows to be removed

**Notes:**  
 This drawing to be read in conjunction with all relevant Architects & Engineers drawings & specifications. For construction and site works refer to Civil Engineering drawings. Do not scale from this drawing. Use figured dimensions only.

Refer also to our Tree Survey Report ref: 19.05.CH.01 dated 30th. May 2019.  
 Retained trees shall be reassessed on completion of the construction phase and may require removal/remedial works following reassessment.

**Site Specific Tree Protection measures:**  
 1. Damage to root structures shall be avoided within the RPA zones marked 'A' during the demolition/construction phases. Refer to the relevant clauses of BS 5837:2012.

2. Topsoil shall not be deposited within these zones and excess topsoil shall be moved off site.

3. During demolition works, refer to clause 7.3 of BS5837:2012. Any excavation/demolition along the verges of RPA zones shall be hand dug only, taking care not to damage or disrupt existing root patterns.

4. Avoid machinery damage to low overhanging Poplar limbs. Assess and prune back and crown raise low limbs that overhang the site, prior to construction machinery entering the site.

5. Removal of any trees on South Dublin City Council property along the northern boundary will require the full consent and permission of the Council. Retained trees will be protected during the construction phase. Damage to root structures shall be avoided.

6. Protection of retained trees shall be in accordance with BS 5837:2012. Trees in relation to Design Demolition and Construction - Recommendations.

**Tree Management Services**  
 Arboriculture, Landscape and Forestry Consultants  
 21 Castleknock, Ballincollig, Co. Cork  
 T: 021-4874365, M: 086 2532280  
 Email: phelanj1@gmail.com

**PROJECT**  
 PROPOSED RESIDENTIAL DEVELOPMENT AIRTON ROAD

**CLIENT**  
 GREENLEAF HOMES LIMITED

**DRAWING**  
 TREE PROTECTION PLAN

DRAWING No. 27.01.15.01A Status: Planning SCALE: 1:500 APPROX @ A1  
 Date: 13-02-20 Sheet: 1

**TREE PROTECTION PLAN**

Note: Retention of existing trees shown subject to further assessment during the construction phase.